

DART Orange Line to North Irving/DFW

## Lake Carolyn Parkway

### Construction Update



The DART Orange Line construction is quickly moving along the corridor and into the Lake Carolyn Pkwy area. In an attempt to minimize impacts, weekly construction updates are emailed out. This helps provide a more definitive answer to many construction questions, and provides notice to areas that may experience upcoming traffic delays or construction activity.

You can register for Orange Line Construction Updates online at [www.dart.org](http://www.dart.org).

These lane restrictions are needed to provide a safe work area as crews continue utility relocation work and prepare for future construction activities. As construction proceeds over the next couple of years, additional lane restrictions and configuration changes will be needed to accommodate other construction activities. Signage will be present to direct motorists.

*The following configuration is scheduled to begin on Monday, November 2, 2009 and will remain in place for 2-4 weeks. Please note that all dates are tentative as they do not account for weather delays or other schedule impacts.*

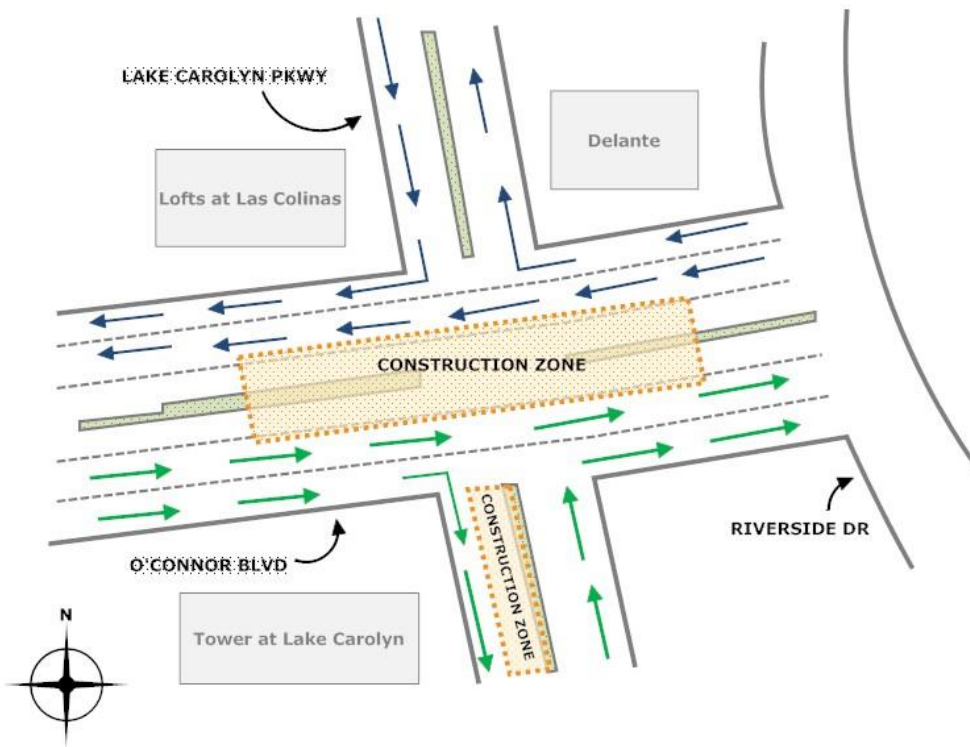

Utility relocations will begin in the median of Lake Carolyn Pkwy and O'Connor Blvd. These activities will require traffic delays along O'Connor Blvd and Lake Carolyn Pkwy for 2-4 weeks as crews complete these activities. Signage will be present to direct motorists.

For the safety of everyone, pedestrian and cycle traffic are not permitted in construction zones. Please use alternate routes.

Please use caution when traveling through construction zones, observe any changes to speed limits or detours, and be aware of the construction workers delivering this project.

Jessica Torneten  
KSWRP  
Public Information  
972-374-4453  
214-498-3037  
Jessica.torneten@kiewit.com

Carlos Huerta  
DART  
Community Affairs  
Representative  
214.749.2721  
chuerta@dart.org



214.979.1111  
www.DART.org